



For construction, maintenance, cleaning and demolition risk refer to the relevant method statements and risk assessments related to this task for scheme Ref. C2015_BC/00xxx_YY.
 In addition to the hazards/risks normally associated with the types of work detailed on this drawing take note of the following. All works on this drawing will be carried out by a competent contractor working to an appropriate method statement and risk assessment.

NOTES:

LEGEND:

-  New road markings
-  Existing road markings to be removed

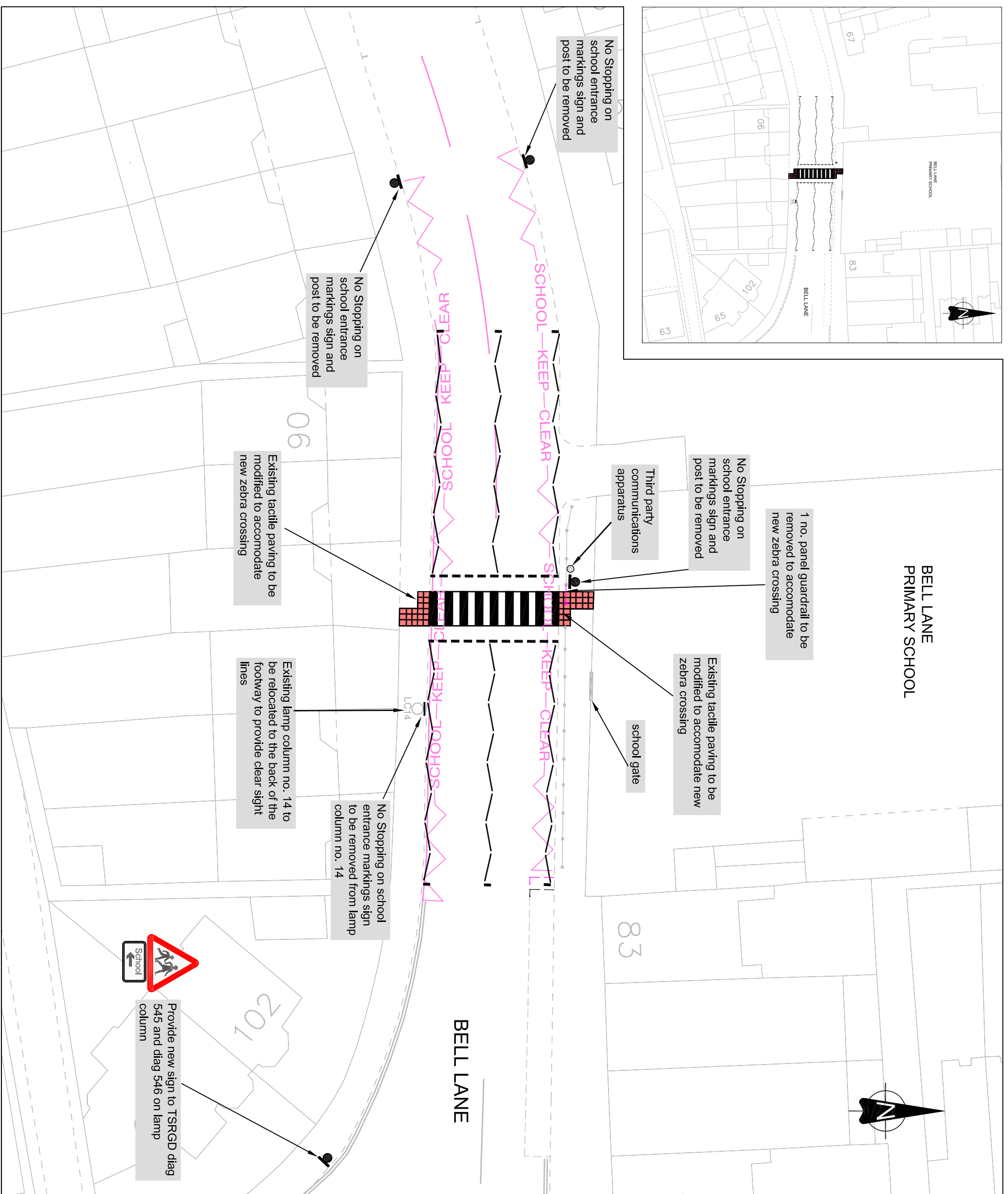

This product includes mapping data licensed from Ordnance Survey with the permission of the Controller of Her Majesty's Stationery Office.
 © Crown copyright and database right 2016. All rights reserved.
 London Borough of Barnet Licence No 100017674

REVISION

Revision Details	Design/Check	Date	Rev.

Purpose of issue

DRAFT

Client:



Scheme title
RE Scheme Ref. C2015_BC/00xxx_YY

Drawing title
**BELL LANE
 ZEBRA CROSSING**
 PRELIMINARY DESIGN
 OPTION 1

Scale @ A3:

Design	Drawn	Checked	Approved
xx	xx	xx	xx
DATE: xx/xx/xx	DATE: xx/xx/xx	DATE: xx/xx/xx	DATE: xx/xx/xx



Traffic and Development
 London Borough of Barnet, Barnet House,
 11th Floor, Highways, 1255 High Road,
 Whitehall, London N20 0EJ

C2016_BC/001031_08-DESIGN-01
 Ref: 0