Meeting	Licensing Sub-Committee
Date	11 th April 2014
Subject	McDonalds, Great North Leisure Park, Chaplin Square, North Finchley, N12 0GL
Report of	Trading Standards & Licensing Manager
Summary	This report asks the Sub-Committee to consider the application for a new Premises Licence, under section 17 of the Licensing Act 2003.

Officer Contributors	Daniel Pattenden – Licensing Officer
Status (public or exempt)	Public
Wards Affected	Woodhouse
Enclosures	Report of the Licensing Officer Annex 1 – Application Form Annex 2 – Current Premises Licence Annex 3 – Representations Annex 4 – Matters for decision
For decision:	Licensing Sub-Committee
Function of:	Council
Reason for urgency / exemption from call-in (if appropriate)	Not applicable
Contact for Further Information:	Daniel Pattenden 020 8359 7443; daniel.pattenden@barnet.gov.uk

RECOMMENDATIONS

- 1.1 That the Sub-Committee considers the application for a variation of the Premises License for McDonalds, Great North Leisure Park, Chaplin Square, North Finchley, N12 0GL

2. RELEVANT PREVIOUS DECISIONS

- 2.1 None.

3. CORPORATE PRIOTY AND POLICY CONSIDERATIONS

- 3.1 The Council's Licensing policy.

4. RISK MANAGEMENT ISSUES

- 4.1 Not applicable.

5. EQUALITIES AND DIVERSITY ISSUES

- 5.1 Licence applications are dealt with according to the provisions of the Licensing Act 2003 and associated Regulations which allow both applications and representations to applications to be made by all sectors of the community.

6. USE OF RESOURCES IMPLICATIONS (Finance, Procurement, Performance & Value for Money, Staffing, IT, Property, Sustainability)

- 6.1 None.

7. LEGAL ISSUES

- 7.1 Valid representations have been received to the application, which is therefore before the Sub-Committee for consideration.

8. CONSTITUTIONAL POWERS

- 8.1 The Licensing Sub-Committee will discharge the functions under the Licensing Act 2003 and associated Regulations, as delegated to it by the Licensing Committee.

9. BACKGROUND INFORMATION

- 9.1 The application and report of the Licensing Officer and appendices are attached to this report.

10. LIST OF BACKGROUND PAPERS

- 10.1 None.

Cleared by Legal (Officer's initials)	BH
--	-----------

Officers Report

This page is intentionally left blank

LICENSING ACT 2003

OFFICERS REPORT

McDonalds Restaurant, Great North Leisure Park, Chaplin Square, North Finchley, N12 0GL

1. The Applicants

The application was submitted by Joshua Simons & Associates on behalf of Appt Corporation Ltd t/a McDonalds, Iron Bridge, Uxbridge Road, Southall, UB1 3EG.

2. Application

The application before the sub committee was submitted under Section 34 of the Licensing Act 2003 for a variation of a premises licence. The application seeks to allow the following:

- To allow late night refreshment indoors and outdoors from 23:00hrs until 05:00hrs (24 Hours) Monday to Sunday
- To allow the premises to remain open to the public from 23:00hrs until 05:00hrs (24 Hours) Monday to Sunday
- To remove condition numbers 6 and 9 from the current premises licence. These conditions are:
 - 6. The main restaurant is to be closed to the public at 00:00 hrs.
 - 9. This licence only permits the "Drive through" facility will be in open between the hours of 00:00 and 05:00 Monday - Sunday. The remainder of the premises shall remain closed to the public during this period.

A full copy of the application can be seen in **Annex 1** attached to this application.

3. Current Premises Licence

The current premises licence allows the following activities:

The Provision of late night refreshment - Outdoors only

Standard Days and Timings:

Monday to Sunday 23:00hrs - 05:00hrs

The Playing of recorded music - Indoors only

Standard Days and Timings:

Monday to Sunday 06:00hrs - 00:00hrs

The hours that the premises are open to the public

Standard Days and Timings

Monday to Sunday 00:00hrs - 24:00hrs

The current premises licence can be found attached to this report in Annex 2.

4. Representations

Responsible Authorities

The licensing department have received a representation submitted by Sgt Mark Altman on behalf of the Metropolitan Police.

The Police have stated that they still having concerns that there will be issues of crime and disorder if this premise is permitted to open the restaurant section 24 hours a day.

Other representations

No other representations have been submitted by interested parties

The representation letter can be seen in full in **Annex 3** attached to this report.

5. Attaching conditions

The operating schedule, which is part of the application, includes certain additional steps that the applicant will take to protect the licensing objectives. These will become enforceable conditions, should the licence be granted. Additional conditions may be attached to the licence if the committee thinks it appropriate.

The Committee must have regard to all of the representations made and the evidence it hears, and is asked to note that it may not attach conditions or reject the whole or part of the application merely because it considers it desirable to do so. It must actually be appropriate in order to promote the licensing objectives.

In relation to conditions, the statutory guidance at chapter 10.8 states that "The licensing authority may not impose any conditions unless its discretion has been engaged following receipt of relevant representations and it is satisfied as a result of a hearing (unless all parties agree a hearing is not necessary) that it is appropriate to impose conditions to promote one or more of the four licensing objectives.

Full Copies of the Councils Statement of Licensing Policy, the Statutory Guidance to the Act and the Council's Guide to Good Practice at Licensed Premises will be available at the Licensing Sub Committee hearing or in advance if required.

A map centrally locating the premises and a plan shall be made available at the hearing.

Daniel Pattenden
Licensing Officer

Annex 1 – Application Form
Annex 2 – Current Premises Licence
Annex 3 – Representation
Annex 4 – Matters for decision

This page is intentionally left blank

Variation Application Form

This page is intentionally left blank

* required information

Section 1 of 17

You can save the form at any time and resume it later. You do not need to be logged in when you resume.

System reference

Not Currently In Use

This is the unique reference for this application generated by the system.

Your reference

PRE-LIC-VAR-GNLP

You can put what you want here to help you track applications if you make lots of them. It is passed to the authority.

Are you an agent acting on behalf of the applicant?

☒ Yes☐ No

Put "no" if you are applying on your own behalf or on behalf of a business you own or work for.

Applicant Details

* First name

Joshua Simons & Associates

* Family name

Ltd

* E-mail

jsimons@jsaal.co.uk

Main telephone number

07725418439

Include country code.

Other telephone number

☐ Indicate here if the applicant would prefer not to be contacted by telephone

Is the applicant:

☒ Applying as a business or organisation, including as a sole trader☐ Applying as an individual

A sole trader is a business owned by one person without any special legal structure. Applying as an individual means the applicant is applying so the applicant can be employed, or for some other personal reason, such as following a hobby.

Applicant Business

* Is the applicant's business registered in the UK with Companies House?

☒ Yes☐ No

* Registration number

05812951

* Business name

Appt Corporation Ltd

If the applicant's business is registered, use its registered name.

* VAT number

-

Unknown

Put "none" if the applicant is not registered for VAT.

* Legal status

Private Limited Company

Continued from previous page...

* Applicant's position in the business

Home country

The country where the applicant's headquarters are.

Registered Address

Address registered with Companies House.

* Building number or name

* Street

District

* City or town

County or administrative area

* Postcode

* Country

Agent Details

* First name

* Family name

* E-mail

Main telephone number

Include country code.

Other telephone number

☐ Indicate here if you would prefer not to be contacted by telephone

Are you:

☒ An agent that is a business or organisation, including a sole trader

A sole trader is a business owned by one person without any special legal structure.

☐ A private individual acting as an agent

Agent Business

* Is your business registered in the UK with Companies House? ☒ Yes ☐ No

* Registration number

* Business name

If your business is registered, use its registered name.

* VAT number

Put "none" if you are not registered for VAT.

* Legal status

Continued from previous page...

* Your position in the business

Home country

The country where the headquarters of your business is located.

Agent Registered Address

Address registered with Companies House.

* Building number or name

* Street

District

* City or town

County or administrative area

* Postcode

* Country

Section 2 of 17

APPLICATION DETAILS

This application cannot be used to vary the licence so as to extend the period for which the licence has effect or to vary substantially the premises to which it relates. If you wish to make that type of change to the premises licence, you should make a new premises licence application under section 17 of the Licensing Act 2003.

I/we, as named in section 1, being the premises licence holder, apply to vary a premises licence under section 34 of the Licensing Act 2003 for the premises described in section 2 below.

* Premises Licence Number

Are you able to provide a postal address, OS map reference or description of the premises?

☒ Address ☐ OS map reference ☐ Description

Postal Address Of Premises

Building number or name

Street

District

City or town

County or administrative area

Postcode

Country

Premises Contact Details

Telephone number

Continued from previous page...

Non-domestic rateable
value of premises (£)

85,500

Section 3 of 17

VARIATION

Do you want the proposed
variation to have effect as
soon as possible?

☒ Yes

☐ No

Do you want the proposed variation to have effect in relation to the
introduction of the late night levy?

☐ Yes

☒ No

You do not have to pay a fee if the only
purpose of the variation for which you are
applying is to avoid becoming liable to the
late night levy.

If your proposed variation
would mean that 5,000 or
more people are expected to
attend the premises at any
one time, state the number
expected to attend

Describe Briefly The Nature Of The Proposed Variation

Describe the premises. For example the type of premises, its general situation and layout and any other information which could be relevant to the licensing objectives. Where your application includes off-supplies of alcohol and you intend to provide a place for consumption of these off-supplies, you must include a description of where the place will be and its proximity to the premises.

The premises is located at Unit 3 within a retail park known as Great North Leisure Park.

The proposed application seeks the following variations:

To extend the sale of late night refreshment for the in store restaurant dining area between 23:00 and 05:00 Mondays to Sundays inclusive for 7 days a week as per layout plan 4672-0654_50 Revision J that accompanies this application.

To remove conditions 6, 7 and 10.

No other variation/s are sought.

Section 4 of 17

PROVISION OF PLAYS

Will the schedule to provide plays be subject to change if this application to
vary is successful?

☐ Yes

☒ No

Section 5 of 17

PROVISION OF FILMS

Will the schedule to provide films be subject to change if this application to
vary is successful?

☐ Yes

☒ No

Continued from previous page...

Section 6 of 17

PROVISION OF INDOOR SPORTING EVENTS

Will the schedule to provide indoor sporting events be subject to change if this application to vary is successful?

☐ Yes ☒ No

Section 7 of 17

PROVISION OF BOXING OR WRESTLING ENTERTAINMENTS

Will the schedule to provide boxing or wrestling entertainments be subject to change if this application to vary is successful?

☐ Yes ☒ No

Section 8 of 17

PROVISION OF LIVE MUSIC

Will the schedule to provide live music be subject to change if this application to vary is successful?

☐ Yes ☒ No

Section 9 of 17

PROVISION OF RECORDED MUSIC

Will the schedule to provide recorded music be subject to change if this application to vary is successful?

☐ Yes ☒ No

Section 10 of 17

PROVISION OF PERFORMANCES OF DANCE

Will the schedule to provide performances of dance be subject to change if this application to vary is successful?

☐ Yes ☒ No

Section 11 of 17

PROVISION OF ANYTHING OF A SIMILAR DESCRIPTION TO LIVE MUSIC, RECORDED MUSIC OR PERFORMANCES OF DANCE

Will the schedule to provide anything similar to live music, recorded music or performances of dance be subject to change if this application to vary is successful?

☐ Yes ☒ No

Section 12 of 17

PROVISION OF LATE NIGHT REFRESHMENT

Will the schedule to provide late night refreshment be subject to change if this application to vary is successful?

☒ Yes ☐ No

Continued from previous page...

Standard Days And Timings

MONDAY

Start

End

Start

End

Provide timings in 24 hour clock (e.g., 16:00) and only give details for the days of the week when you intend the premises to be used for the activity.

TUESDAY

Start

End

Start

End

WEDNESDAY

Start

End

Start

End

THURSDAY

Start

End

Start

End

FRIDAY

Start

End

Start

End

SATURDAY

Start

End

Start

End

SUNDAY

Start

End

Start

End

Will the provision of late night refreshment take place indoors or outdoors or both?

☒ Indoors ☐ Outdoors ☐ Both

Where taking place in a building or other structure select as appropriate. Indoors may include a tent.

State type of activity to be authorised, if not already stated, and give relevant further details, for example (but not exclusively) whether or not music will be amplified or unamplified.

Provision of hot food and beverages from the in restaurant dining area as shown on plans 4672_0654_50 Revision J.

State any seasonal variations.

For example (but not exclusively) where the activity will occur on additional days during the summer months.

Continued from previous page...

To add one hour to the start of British Summer Time.

Non standard timings. Where the premises will be used for the provision of late night refreshment at different times from those listed above, list below.

For example (but not exclusively), where you wish the activity to go on longer on a particular day e.g. Christmas Eve.

Not applicable.

Section 13 of 17

SUPPLY OF ALCOHOL

Will the schedule to supply alcohol be subject to change if this application to vary is successful?

☐ Yes

☒ No

Section 14 of 17

ADULT ENTERTAINMENT

Highlight any adult entertainment or services, activities, or other entertainment or matters ancillary to the use of the premises that may give rise to concern in respect of children.

Provide information about anything intended to occur at the premises or ancillary to the use of the premises which may give rise to concern in respect of children, regardless of whether you intend children to have access to the premises, for example (but not exclusively) nudity or semi-nudity, films for restricted age groups etc gambling machines etc.

Not applicable.

Section 15 of 17

HOURS PREMISES ARE OPEN TO THE PUBLIC

Standard Days And Timings

MONDAY

Start

End

Start

End

Provide timings in 24 hour clock (e.g., 16:00) and only give details for the days of the week when you intend the premises to be used for the activity.

TUESDAY

Start

End

Start

End

WEDNESDAY

Start

End

Start

End

Continued from previous page...

THURSDAY

Start 00:00

End 24:00

Start

End

FRIDAY

Start 00:00

End 24:00

Start

End

SATURDAY

Start 00:00

End 24:00

Start

End

SUNDAY

Start 00:00

End 24:00

Start

End

State any seasonal variations.

For example (but not exclusively) where the activity will occur on additional days during the summer months.

1 Hour to be added to the start of British Summer Time.

Non standard timings. Where you intend to use the premises to be open to the members and guests at different times from those listed above, list below.

For example (but not exclusively), where you wish the activity to go on longer on a particular day e.g. Christmas Eve.

Not applicable.

Identify those conditions currently imposed on the licence which you believe could be removed as a consequence of the proposed variation you are seeking.

Conditions 6, 7 and 10.

☐ I have enclosed the premises licence

☐ I have enclosed the relevant part of the premises licence

Continued from previous page...

Reasons why I have failed to enclose the premises licence or relevant part of premises licence.

The premises licence is to be sent under separate cover.

Section 16 of 17

LICENSING OBJECTIVES

Describe the steps you intend to take to promote the four licensing objectives:

a) General – all four licensing objectives (b,c,d,e)

If the club wishes members and their guests to be able to consume alcohol on the premises select on, if the club wishes people to be able to purchase alcohol to consume away from the premises select off. If the club wishes people to be able to do both select both.

As per existing operating schedule contained under premises licence LN/199905722.

b) The prevention of crime and disorder

As per existing operating schedule contained under premises licence LN/199905722.

c) Public safety

As per existing operating schedule contained under premises licence LN/199905722.

d) The prevention of public nuisance

As per existing operating schedule contained under premises licence LN/199905722.

e) The protection of children from harm

As per existing operating schedule contained under premises licence LN/199905722.

Section 17 of 17

PAYMENT DETAILS

This fee must be paid to the authority. If you complete the application online, you must pay it by debit or credit card.

Variation Fees are determined by the non domestic rateable value of the premises.

To find out a premises non domestic rateable value go to the Valuation Office Agency site at <http://www.voa.gov.uk/>

Continued from previous page...

business_rates/index.htm

Band A - No RV to £4300	£100.00
Band B - £4301 to £33000	£190.00
Band C - £33001 to £8700	£315.00
Band D - £87001 to £12500	£450.00*
Band E - £125001 and over	£635.00*

*If the premises rateable value is in Bands D or E and the premises is primarily used for the consumption of alcohol on the premises then you are required to pay a higher fee

Band D - £87001 to £12500	£900.00
Band E - £125001 and over	£1,905.00

If you own a large premise you are subject to additional fees based upon the number in attendance at any one time

Capacity 5000-9999	£1,000.00
Capacity 10000 -14999	£2,000.00
Capacity 15000-19999	£4,000.00
Capacity 20000-29999	£8,000.00
Capacity 30000-39000	£16,000.00
Capacity 40000-49999	£24,000.00
Capacity 50000-59999	£32,000.00
Capacity 60000-69999	£40,000.00
Capacity 70000-79999	£48,000.00
Capacity 80000-89999	£56,000.00
Capacity 90000 and over	£64,000.00

* Fee amount (£)

ATTACHMENTS

AUTHORITY POSTAL ADDRESS

Address

Building number or name	<input type="text"/>
Street	<input type="text"/>
District	<input type="text"/>
City or town	<input type="text"/>
County or administrative area	<input type="text"/>
Postcode	<input type="text"/>
Country	<input type="text" value="United Kingdom"/>

DECLARATION

* I/we understand it is an offence, liable on conviction to a fine up to level 5 on the standard scale, under section 158 of the licensing act 2003, to make a false statement in or in connection with this application.

☐ Ticking this box indicates you have read and understood the above declaration

This section should be completed by the applicant, unless you answered "Yes" to the question "Are you an agent acting on behalf of the applicant?"

Continued from previous page...

* Full name

* Capacity

Date (dd/mm/yyyy)

Add another signatory

Once you're finished you need to do the following:

1. Save this form to your computer by clicking file/save as...

2. Go back to <https://www.gov.uk/apply-for-a-licence/premises-licence/barnet/change-1> to upload this file and continue with your application.

Don't forget to make sure you have all your supporting documentation to hand.

IT IS AN OFFENCE, LIABLE ON SUMMARY CONVICTION TO A FINE NOT EXCEEDING LEVEL 5 ON THE STANDARD SCALE, UNDER SECTION 158 OF THE LICENSING ACT 2003, TO MAKE A FALSE STATEMENT IN OR IN CONNECTION WITH THIS APPLICATION

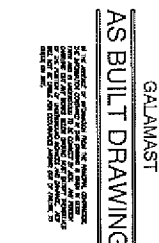

AREA SURVEILLED	END MAY	PROP. COPIES
TOTAL COPIES	43	149
CLUBS - CP	2,800 (64)	360 (89)
	23 (704)	10 (207)
DATA - CP		
DRINKING INTERNAL AREA (ml)	50 ml	238 ml
WASH INTERNAL AREA (ml)	13. ml	13 ml
CHANG ROOM INTERNAL AREA (ml)	3. ml	8 ml

LIM EXTREME



10/2/2004 3:22 PM

[illegible]

Current Premises Licence

This page is intentionally left blank

Licensing Act 2003 Part A: Premises Licence Premises Licence Number: LN/199905722	Licensing Authority: London Borough of Barnet, Building 4, North London Business Park Oakleigh Road South New Southgate, London, N11 1NP LPRL/07/18098 (08/03/2013)
--	---

Part 1 – Premises details

Postal address of premises, or if none, ordnance survey map reference or description McDonalds Restaurants, Unit 3, Great North Leisure Park, Chaplin Square	
Post Town London	Post code N12 0GL
Telephone number 020 8445 6101	
Where the licence is time limited the dates This premises licence is not time limited	
Licensable activities authorised by the licence The Provision of Regulated Entertainment, and The Provision of Late Night Refreshment	
The times the licence authorises the carrying out of licensable activities <u>The Provision of late night refreshment - Outdoors only</u> <u>Standard Days and Timings:</u> Monday to Sunday 23:00hrs - 05:00hrs <u>The Playing of recorded music - Indoors only</u> <u>Standard Days and Timings:</u> Monday to Sunday 06:00hrs - 00:00hrs	
The hours that the premises are open to the public <u>Standard Days and Timings</u> Monday to Sunday 00:00hrs - 24:00hrs	
Where the licence authorises supplies of alcohol whether these are on and/ or off supplies N/A	

Part 2

Name, (registered) address, telephone number and email (where relevant) of holder of premises licence

Appt Corporation Limited
McDonalds
Uxbridge Road
Iron Bridge
Southall, Middlesex
UB1 3EG

Registered number of holder, for example company number, charity number (where applicable)

01002769

Name, address and telephone number of designated premises supervisor where the premises licence authorises for the supply of alcohol

N/A

Personal licence number and issuing authority of personal licence held by designated premises supervisor where the premises licence authorises for the supply of alcohol

N/A

Annex 1 - Mandatory Conditions

N/A

Annex 2 – Conditions consistent with the operating schedule

- 1 McDonald's Restaurants Limited will manage the premises in accordance with good management principles to secure, as far as is possible, the promotion of the four licensing objectives.
- 2 When the premises are open to the public, a CCTV system will be operated and maintained and immediate access to the system will be afforded to both the Police and authorised Council Officers.
- 3 McDonald's Restaurants Limited will ensure that the footpath immediately outside the front of the restaurant is kept clear of litter emanating from the premises.
- 4 The licensee shall ensure that the use of the premises shall not cause a nuisance to the nearby residents.
- 5 The total number of persons accommodated at any one time in the premises shall not exceed 100
- 6 The main restaurant is to be closed to the public at 00:00 hrs.
- 7 Litter emanating from the premises and in the immediate area surrounding the drive through will be cleaned up by McDonalds staff.
- 8 The currently installed CCTV system is to be upgraded to a digital system and shall incorporate VRM Vehicle Recognition and provide facial recognition with adequate lighting to support such a system.
- 9 This licence only permits the "Drive through" facility will be in open between the hours of 00:00 and 05:00 Monday - Sunday. The remainder of the premises shall remain closed to the public during this period.
- 10 The drive through lane shall be clearly marked and provided with lighting to secure safe access and exit.
- 11 Litter emanating from the premises in the immediate area surrounding the drive through shall be cleaned up.

Annex 3 – Conditions attached after hearing by the licensing authority

N/A

Annex 4 - Plan

As submitted to the Council with the application for the grant of a premises licence under schedule 8 of the Licensing Act 2003. Reference: LPRL/07/18098

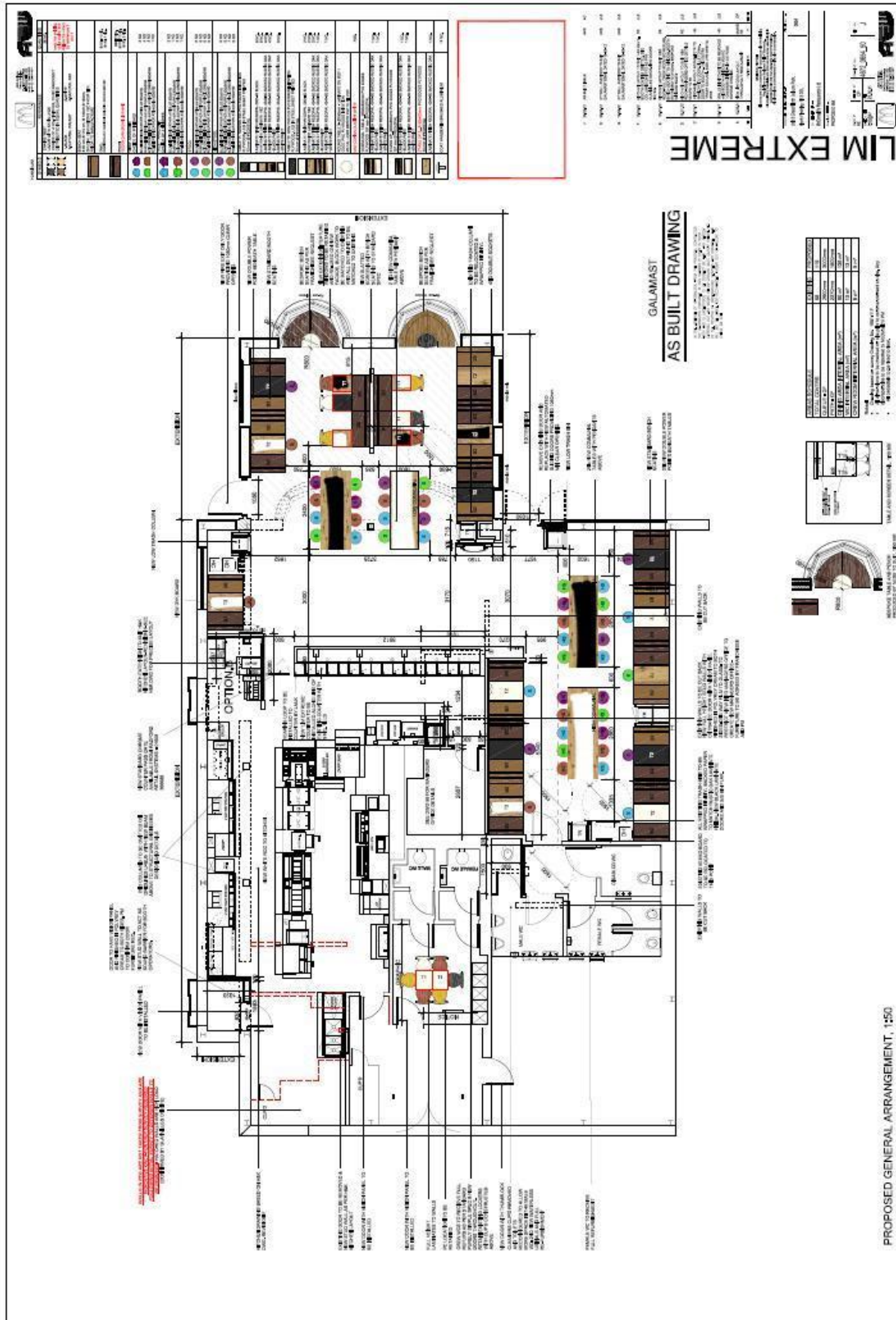

Representation

This page is intentionally left blank



**METROPOLITAN
POLICE**

TOTAL POLICING

With compliments

London Borough Barnet
Licensing Team
Building 4
North London Business Park
Oakleigh Road South
London N11 1NP

**LICENSING OFFICE
COLINDALE POLICE STATION
GRAHAM PARK WAY
COLINDALE
NW95TW**

**Telephone: 020 8733 5261
Facsimile: 020 8733 5268
e-mail: SX_Licensing@met.police.uk
Date: 11th March 2014**

L.B.B. ref:

Our ref: 86/2014

CC: London Borough of Barnet

Police Make Representations to the following application made under

Section(s)	34						Licensing Act 2003
-------------------	-----------	--	--	--	--	--	---------------------------

Application Given To Police On: 19th February 2014

Premises: McDonalds Restaurant Unit 3 Gt North Leisure Park North Finchley N12 0GL

Representations

a) plays (box A)	
b) films (box B)	
c) indoor sporting events (box C)	
d) boxing or wrestling entertainment (box D)	
e) live music (box E)	
f) recorded music (box F)	
g) performances of dance (box G)	
h) anything of a similar description to that falling within (e), (f) or (g) (box H)	
i) making music (box I)	
j) dancing (box J)	
k) entertainment of a similar description to that falling within (i) or (j) (box K)	
l) late night refreshment (box L)	Y
m) alcohol sale by retail (box M)	
n) adult entertainment or services, activities, other entertainment or matters ancillary to the use of the premises that may give rise to concern in respect of children (box N)	

o) Hours premises are open to the public (box O)	Y
--	---

Following a meeting with the applicant and their agent, Joshua Simons, on Friday 7th March 2014. The Police still have concerns that there will be issues of crime and disorder if these premises are permitted to open the restaurant section 24 hours a day.

The premises have operated a 24 hour drive through service since 2011. At this time the Police raised concerns re these premises and other similar venues opening the restaurant areas. It was agreed that the operation would be a purely drive through one, whereby the operator could more readily control any difficult customers and refuse service with little risk of any direct conflict.

It is far easier to control a potentially violent situation if neither party is in direct contact with the other. This is the current position at the premises. All transactions between midnight and 5am are made via the intercom ordering system and served at the security hatch. There is no service to persons other than those in vehicles, hence it is very unlikely that people will loiter on foot in the area, or gather in groups once they have purchased their food.

This situation is more than likely to change if the restaurant opens 24 hours a day. The venue will then become more attractive to younger people who don't drive. It is also likely to become a meeting point where the less desirable elements of society will gather in the early hours of the morning.

It is far more difficult to prevent this and move these groups on once they have become ensconced inside the premises. In turn this is likely to lead to the Police being called to deal with these individuals.

The Police have considered suggestions of an "automatic number plate reader" (ANPR) and use of registered door supervisors from a company on the approved contractors list. It is unlikely that either of these measures would eliminate the likely increase in crime and disorder. However the Police would welcome their consideration if the Licensing Sub Committee decides to grant the application.

The Police respectfully request that the Licensing Sub Committee do not grant this application.

This is in order to promote the four licensing objectives and ensure that the public are not adversely affected by a 24 hour restaurant operation, and Police resources are not called upon to deal with incidents at the premises. The Police are concerned that these premises will become a focal point for local youths to gather and also adversely contribute to alcohol related crime and disorder.

Yours Sincerely,



Police Sergeant Mark ALTMAN

Matters for Decision

This page is intentionally left blank

MATTERS FOR DECISION

McDonalds, Great North Leisure Park, Chaplin Square, North Finchley, N12 0GL

To allow late night refreshment indoors and outdoors

Standard Days and Timings

Day	Proposed start time	Proposed finish time	Granted as application	Amended to:	Refused
Monday	23:00	05:00			
Tuesday	23:00	05:00			
Wednesday	23:00	05:00			
Thursday	23:00	05:00			
Friday	23:00	05:00			
Saturday	23:00	05:00			
Sunday	23:00	05:00			

Added conditions, if any:

Reasons for decisions above:

Hours premises are open to the public

Standard Days and Timings

Day	Proposed start time	Proposed finish time	Granted as application	Amended to:	Refused
Monday	00:00	24:00 (24 Hours)			
Tuesday	00:00	24:00 (24 Hours)			
Wednesday	00:00	24:00 (24 Hours)			
Thursday	00:00	24:00 (24 Hours)			
Friday	00:00	24:00 (24 Hours)			
Saturday	00:00	24:00 (24 Hours)			
Sunday	00:00	24:00 (24 Hours)			

Added conditions, if any:

Reasons for decisions above:

The applicants seek to remove the following conditions:

Conditions to be removed	Granted	Refused	Amended
6. The main restaurant is to be closed to the public at 00:00 hrs.			
9. This licence only permits the "Drive through" facility will be in open between the hours of 00:00 and 05:00 Monday - Sunday. The remainder of the premises shall remain closed to the public during this period.			